

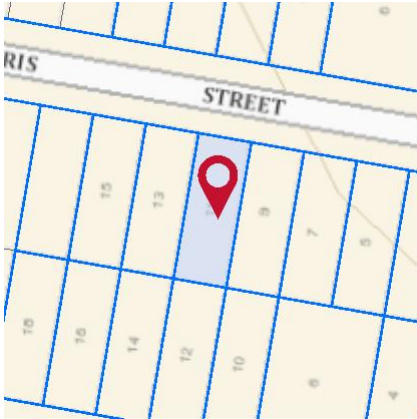

Property Report

11 HARRIS STREET CONDELL PARK 2200



Property Details

Address: 11 HARRIS STREET CONDELL PARK 2200
Lot/Section 37/-/DP14055
/Plan No:
Council: CANTERBURY-BANKSTOWN COUNCIL

Summary of planning controls

Planning controls held within the Planning Database are summarised below. The property may be affected by additional planning controls not outlined in this report. Please contact your council for more information.

Local Environmental Plans	Canterbury-Bankstown Local Environmental Plan 2023 (pub. 23-6-2023)
Land Zoning	IN1 - General Industrial: (pub. 23-6-2023)
Height Of Building	NA
Floor Space Ratio	1:1
Minimum Lot Size	1500 m ²
Heritage	NA
Land Reservation Acquisition	NA
Foreshore Building Line	NA
Local Provisions	30 km Area 1

Detailed planning information

State Environmental Planning Policies which apply to this property

State Environmental Planning Policies can specify planning controls for certain areas and/or types of development. They can also identify the development assessment system that applies and the type of environmental assessment that is required.

This report provides general information only and does not replace a Section 10.7 Certificate (formerly Section 149)



Property Report

11 HARRIS STREET CONDELL PARK 2200

- State Environmental Planning Policy (Biodiversity and Conservation) 2021: Excluded (pub. 21-10-2022)
- State Environmental Planning Policy (Biodiversity and Conservation) 2021: Georges River Catchment (pub. 21-10-2022)
- State Environmental Planning Policy (Biodiversity and Conservation) 2021: Land Application (pub. 2-12-2021)
- State Environmental Planning Policy (Biodiversity and Conservation) 2021: Subject Land (pub. 2-12-2021)
- State Environmental Planning Policy (Exempt and Complying Development Codes) 2008: Land Application (pub. 12-12-2008)
- State Environmental Planning Policy (Housing) 2021: Land Application (pub. 26-11-2021)
- State Environmental Planning Policy (Industry and Employment) 2021: Land Application (pub. 2-12-2021)
- State Environmental Planning Policy (Planning Systems) 2021: Land Application (pub. 2-12-2021)
- State Environmental Planning Policy (Primary Production) 2021: Land Application (pub. 2-12-2021)
- State Environmental Planning Policy (Resilience and Hazards) 2021: Land Application (pub. 2-12-2021)
- State Environmental Planning Policy (Resources and Energy) 2021: Land Application (pub. 2-12-2021)
- State Environmental Planning Policy (Sustainable Buildings) 2022: Land Application (pub. 29-8-2022)
- State Environmental Planning Policy (Transport and Infrastructure) 2021: Land Application (pub. 2-12-2021)
- State Environmental Planning Policy No 65—Design Quality of Residential Apartment Development: Land Application (pub. 26-7-2002)

Other matters affecting the property

Information held in the Planning Database about other matters affecting the property appears below. The property may also be affected by additional planning controls not outlined in this report. Please speak to your council for more information

Greater Sydney Tree Canopy Cover 2019 Percentage	1.07
Greater Sydney Tree Canopy Cover 2022 Percentage	2.02
Housing and Productivity Contribution	Housing and Productivity Contribution Greater Sydney Region_A&A
Local Aboriginal Land Council	GANDANGARA
Regional Plan Boundary	Greater Sydney

This report provides general information only and does not replace a Section 10.7 Certificate (formerly Section 149)